

TM 508005L Bow Chain Stopper

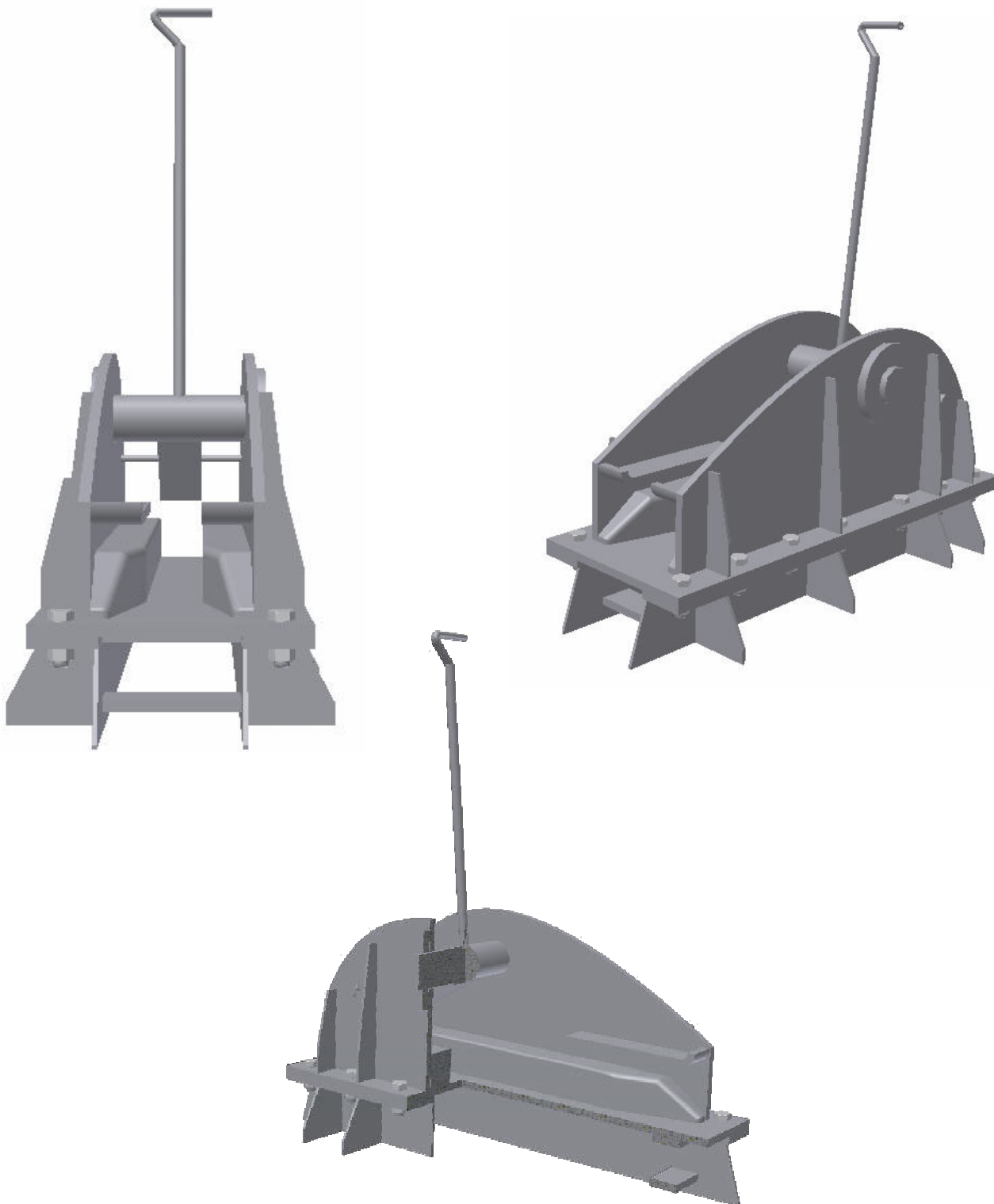

SECTION VIEW

See reverse for details ⇒

**TECH-MARINE EQUIPMENT APS
ESRUMVEJ 421 • 3080 TIKØB • DENMARK**

E-mail: Tech-Marine@Tech-Marine.dk • www.tech-marine.dk
Phone +45 4970 4395 • Fax +45 4970 1769 • CVR 25 99 96 49

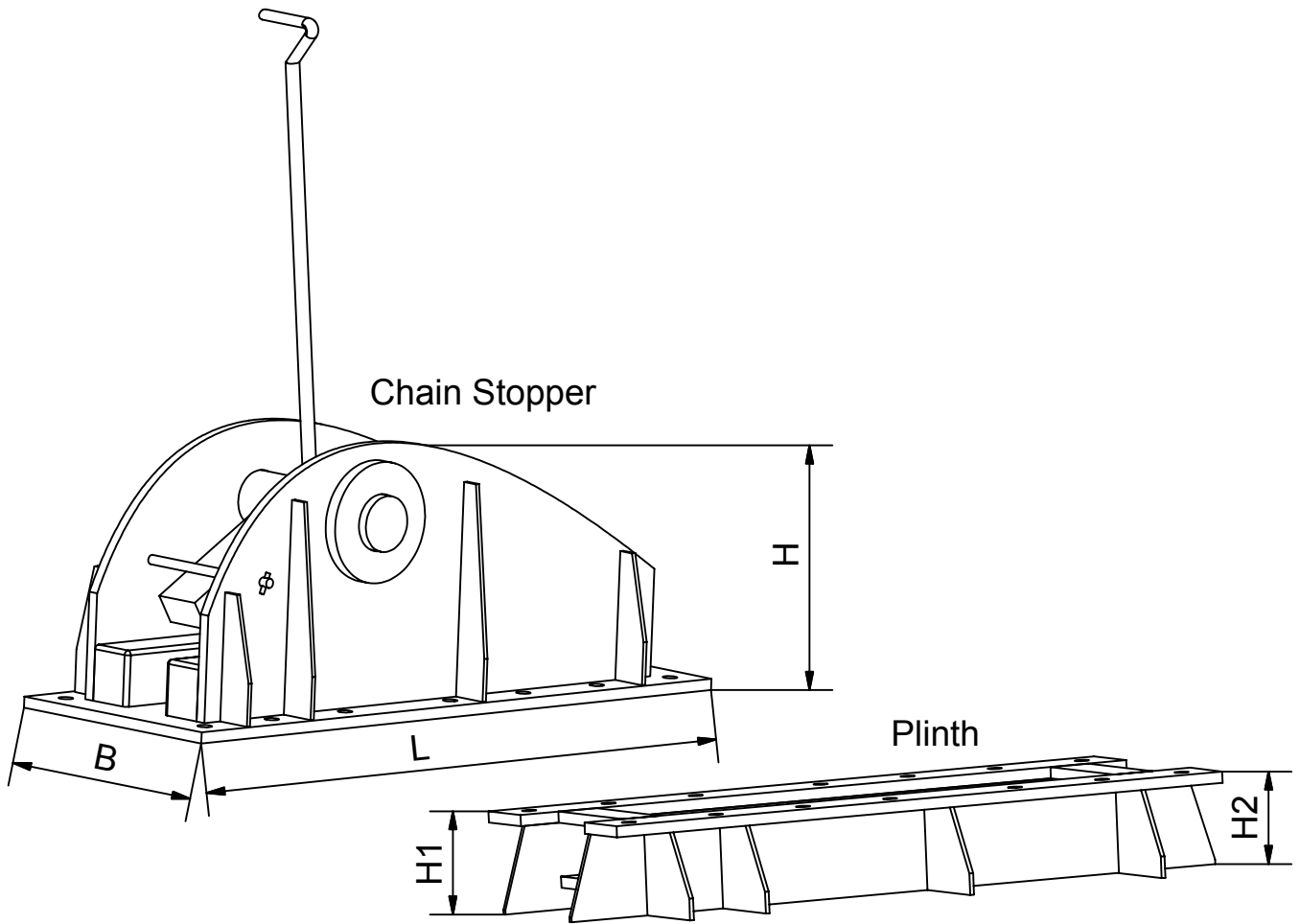

Chain stopper							Plinth		
Chain diameter	LR. Grade	SWL, tonnes	L	B	H	Weight kg	H1	H2	Weight kg
54	U3	100	1300	400	635	608	200	200	119
76	U3	200	1600	600	645	1106	200	200	178
76	U4	250	1600	600	645	1390	200	200	223

Material: S355 - EN 10025 or equivalent

Surface treatment:
SA 2.5 + 25 my HEMPEL shop primer ZS 15890 Grey

Certificate: 3.1 - EN 10204:2004. Optional with class certificate
Tolerances: EN13920 / 22768-1

Design load 1.5 x SWL
Allowable stresses 100/60 % of min yield point

The chain stoppers comply with OCIMF guidance " Recommendations for equipment employed in the mooring of ships at single point moorings" and IMO resolution MSC 35 (63) of 20 May 1994 for emergency towing arrangements

Order:
Chain Stopper TM508005L CH-chain size-chain grade
Example: TM508005L CH-54-U3
Plinth TM508005L PL-chain size-chain grade H1-H2
Example: TM508005L PL-54-U3 200-200

H1, H2 = 200 mm, standard height.
Different heights may be specified on order

STANDARD

Tech-Marine Equipment ApS Esrumvej 421 - DK 3080 Tikøb Phone. +45 4970 4395 Fax. +45 4970 1769 <small>Existing law protects TMs rights of possession to this drawing. The design or the drawing must not, without permission of TM be published, copied, reproduced, manufactured or exploited in any other way.</small>	TM508005L Bow Chain Stopper	Date	Checked	Revision
		23-03-2009		B
		Sheet	2 of 2	